

POINT *of* VIEW

An International Research
and Dialogue Complex
Dedicated to
Conflict Analysis and
Resolution

“I want my home to be used as an instrument to help people resolve differences and work through disputes in a secluded and restful environment.”

—EDWIN LYNCH



T ABLE OF CONTENTS

- 3 **A Tribute to Edwin and Helen Lynch**
- 3 Their Extraordinary Gift
- 5 **Institute for Conflict Analysis and Resolution**
- 6 **Point of View**
- 6 Mission
- 7 Site Plan
- 9 Program
- 9 Partners
- 10 Natural Setting
- 11 **Facility**
- 11 Building Point of View
- 13 **Phase I: Learning to Engage:**
- 13 Integrated Practice and Learning Center
- 15 **Phase II: Anchoring Dialogue**
- 15 Overnight Retreat Complex
- 17 **Phase III: Discovery and Celebration:**
- 17 International Scholarly Hub

“ICAR’s faculty and students are pioneers in the



field of conflict analysis and resolution. It is fitting that they reside at Mason, one of the country’s most diverse campuses with over 30,000 students from 150 countries.”

—ALAN MERTEN, PRESIDENT,
GEORGE MASON UNIVERSITY





A TRIBUTE TO EDWIN AND HELEN LYNCH

Rendering by Bushman Dreyfus Architects PLC

▲ Secluded meeting and research center.

THEIR EXTRAORDINARY GIFT

To contribute to the development of the field, the Lynches left their 40-acre estate on Belmont Bay in idyllic Mason Neck, Virginia, to the George Mason University's Institute for Conflict Analysis and Resolution.

Edwin Lynch was a long-time Virginia resident, real estate investor, philanthropist and state legislator. Helen Lynch was an artist and musician who enjoyed developing opportunities for young people. Both were deeply committed to building the social and educational fabric of the burgeoning Northern Virginia community.

The Lynches were committed to the field of conflict analysis and resolution, supporting ICAR through their active engagement and generous contributions. They were visionaries who recognized the need to find alternatives to violence. They knew that education and research in the theory and practice of conflict resolution and peace building would be critical to finding solutions to deep-rooted conflicts.



▲ Edwin and Helen Lynch.



Photo by Amanda Martin

I NSTITUTE FOR CONFLICT ANALYSIS AND RESOLUTION

Twenty-five years ago, a small group of practitioners and scholars founded the Institute for Conflict Analysis and Resolution (ICAR) at George Mason University in Fairfax, Virginia. These pioneers, dedicated to social justice and the peaceful resolution of deep-rooted conflict, created the first-ever graduate program in conflict analysis and resolution at ICAR. Under the auspices of the Institute, they built a theoretical and research basis for the emerging discipline.

Since its beginning, ICAR has graduated 550 students from 40 countries. In 2005, ICAR launched one of the nation's first undergraduate programs in conflict analysis and resolution. In 2006 it added a unique professional certificate program.

The field is expanding with more than 75 other graduate programs emerging around the world in the last decade. ICAR currently enrolls more than 250 graduate students and 150 undergraduates. This growth stems from the increasing worldwide demand for expertise in diplomacy, open dialogue and reconciliation.

The escalating number and complexity of conflicts around the globe require comprehensive interventions that build sustainable peace by transforming relationships and changing the nature of social and political interactions. That challenge requires the specialized skills and analytical understanding that ICAR faculty, students and alumni bring to the arena.



▲ Students come to ICAR from all over the world to forge new relations, open critical dialogues and build a cadre of well-trained professionals able to address cultural, religious and economic conflicts in the United States and abroad.

POINT OF VIEW

Point of View fills an emergent need. There is no other space in the world designed specifically for conflict analysis and resolution. Point of View will be the ideal place for transformative conversations, dialogue, reflection and reconciliation.

As the leader in developing the field, ICAR is ideally suited to create Point of View. It will become ICAR's clinical lab site, where groups in conflict come to address differences, engage in dialogue and learn together. The theory and research developed at ICAR will provide the foundation for the practice at Point of View.

“Point of View is a testament to the collective hope that we can develop the knowledge we need to change the course of our histories and that of our children. POV is, in this way, a gift to the world.”

—SARA COBB, ICAR DIRECTOR



As part of George Mason University, Point of View will partner with faculty and students across the campus to create a multidisciplinary center. It will enhance the University's standing in the international, diplomatic and higher education community and enrich the Northern Virginia area.

MISSION

Point of View will be a space for practice, teaching and research. It will be a resource for ICAR, the university, the region, the nation and the world.

Working with the international conflict resolution community, Point of View will be designed to facilitate conflict resolution and reconciliation processes; teach conflict analysis and develop curricular resources; and conduct research to support the development of theory and practice.



▲ Peace walkways and scenic overlook.

Point of View Site Plan. ►

SITE PLAN



NORTH

BELMONT BAY

CANOE RAMP

WOODLAND AMPHITHEATER

DIALOGUE SUITES

GUEST ROOMS

BOARDWALK OVERLOOK

COMMONS SPACE (below)

FACULTY OFFICES
MEETING SPACE
(existing house)

RITUAL SPACE AND TERRACE

DINING TERRACE

LIBRARY + FELLOWS OFFICES
ROOFTOP GARDEN (above)



Rendering by Bushman Dreyfus Architects PLC



ARRIVAL / ADMINISTRATION / LECTURE

WET MEADOW

RESIDENTIAL

PERVIOUS PARKING

MAINTENANCE

← FOLD IN

PROGRAM

The program at Point of View will be three fold:

- **Practice.** Point of View will enable parties with deep differences to engage in conflict resolution and reconciliation processes, *through dialogue, negotiation, mediation and strategic planning*. The site will accommodate day meetings, workshops, conferences, day and overnight retreats, events, private dialogues and international meetings.
- **Teaching.** Point of View will anchor educational programs for students, and professionals, to learn advanced theory and method for conflict resolution. Workshops, seminars, certificate programs, short courses will provide venues for learning.
- **Research.** Point of View will support the development of the field of conflict resolution, by providing a place where the theory of conflict intervention, can be studied, in practice, developing research and practice in tandem. ICAR is proposing to launch the Center for Advanced Studies in Conflict Dynamics and Intervention at Point of View to define future issues and provide ongoing analysis for the field.



PARTNERS

ICAR will invite education partners, as well as those from the public and private sectors who share the vision of Point of View, to participate in the planning and use of the facility.

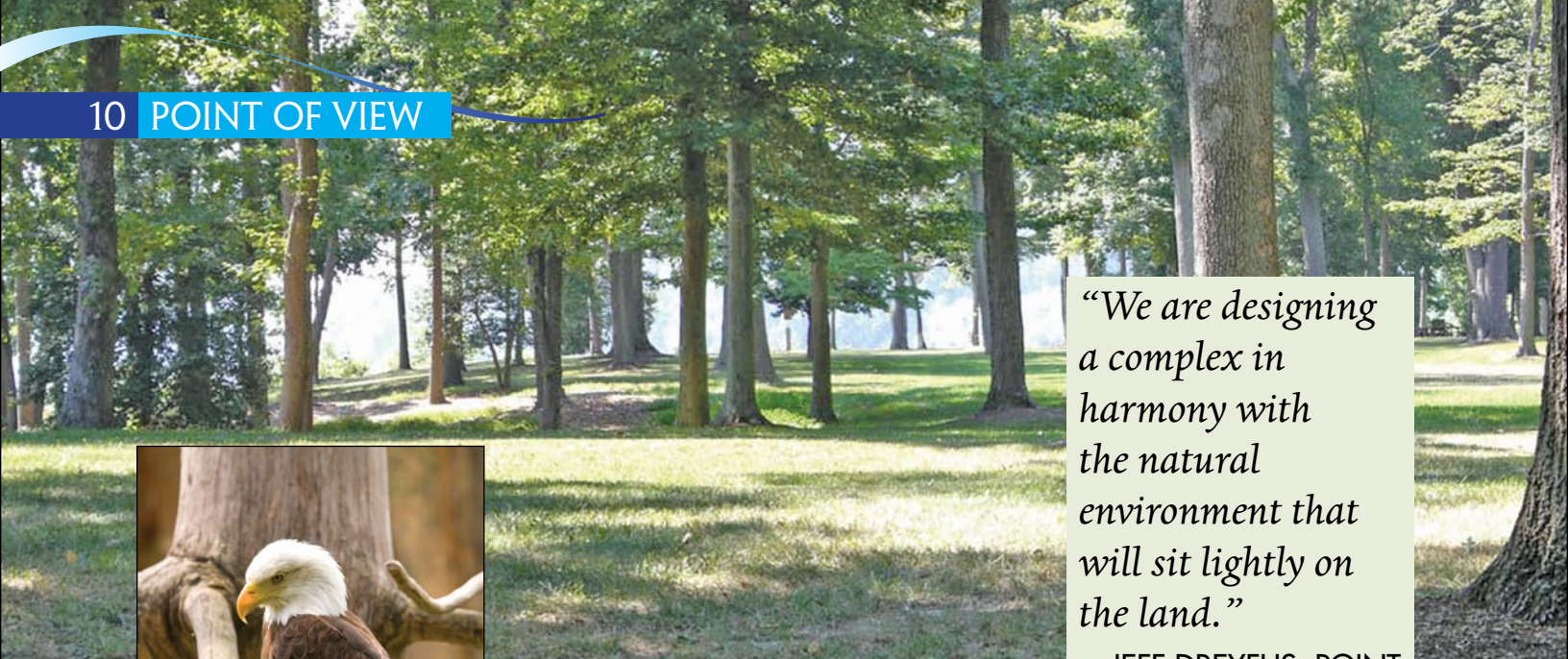

“We are designing a complex in harmony with the natural environment that will sit lightly on the land.”
—JEFF DREYFUS, POINT OF VIEW ARCHITECT



NATURAL SETTING

Point of View is located on 40 pristine, secluded wooded acres next to Belmont Bay in Fairfax County, Virginia, just 25 miles south of Washington, D.C. It is close to Gunston Hall, the country home of George Mason, author of the Virginia Declaration of Rights, which formed the basis of the First Amendment of the U.S. Constitution. The site overlooks the spectacular 2,200-acre Mason Neck National Wildlife Refuge, with nearly six miles of shoreline.

The natural setting and modern, inviting facilities will allow parties in conflict to engage in the critical work of peace building with privacy, security and safety.

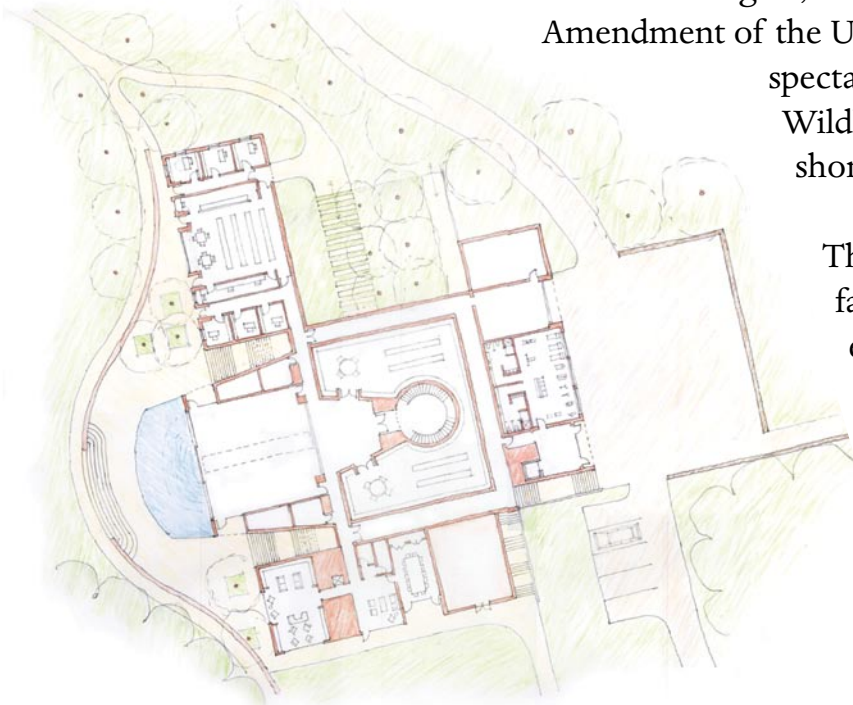

▲ Open dining and indoor recreational space.



Photo by Amanda Martin

FACILITY

BUILDING POINT OF VIEW

Using the Lynch home and its surrounding 40 acres, ICAR will build a 53,000 square foot research and retreat complex that upon completion can accommodate up to 100 participants, including 35 overnight guests.

The complex will feature:

- Large tiered lecture hall for fifty
- Three indoor meeting spaces for twenty-five with break out rooms
- Three small, private and fully-equipped dialogue suites
- Overnight accommodations for thirty-five guests
- Ritual and ceremonial space with reflecting pool
- Library and research archive documenting the field's 25-year history
- State-of-the-art communications systems
- Outdoor woodland amphitheater
- Five faculty offices
- Residential housing for six visiting scholars and graduate fellows
- Open dining and indoor recreational facilities

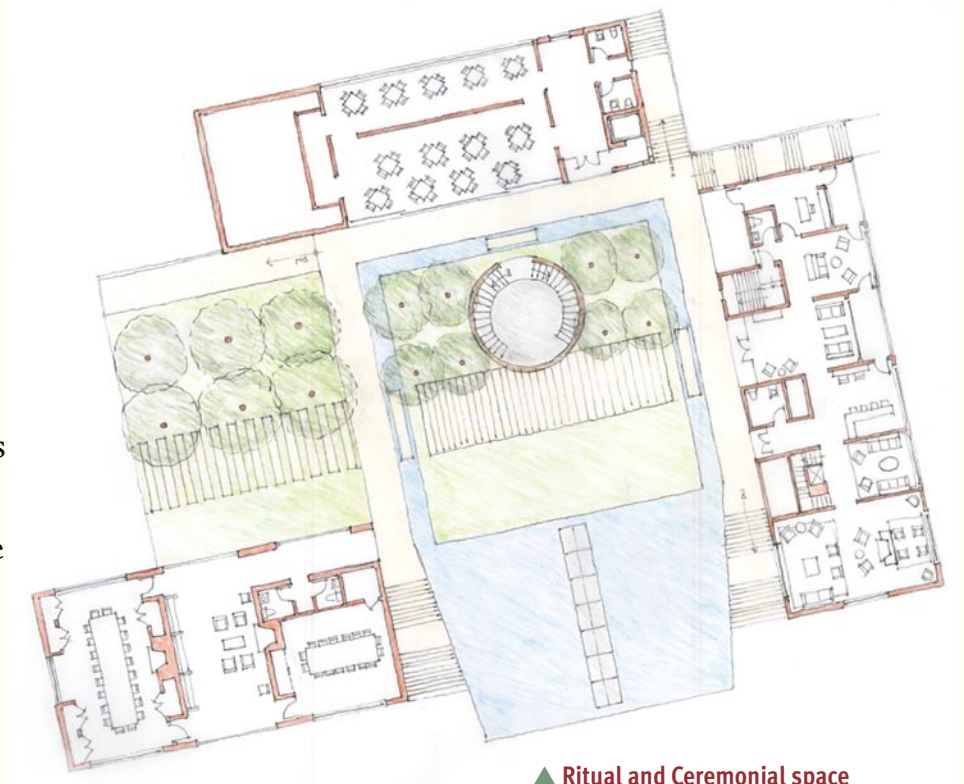

▲ Ritual and Ceremonial space with reflecting pool.

The facility will be built and used in three phases; the total cost will be \$23.9 million.



Photo by Amanda Martin

PHASE I: LEARNING TO ENGAGE:

INTEGRATED PRACTICE AND LEARNING CENTER

Point of View will serve as a dynamic academic hub actively engaging students, faculty, and the international conflict resolution community and area residents. A large lecture hall and space for clinical work will greatly expand educational opportunities for students and professionals.

The initial Point of View facilities will include:

- **Welcome and Lecture Building.** The open glass-enclosed entry hall will lead to a large lecture hall with theater-style seating for 50, small break-out rooms and offices.
- **Dialogue Suites.** Three private suites, accommodating two groups of 10 each, will be built on the bay side of the property providing maximum privacy and quiet, each with private lobby and kitchenette.
- **Outdoor Amphitheater and Peace Walk.** A woodland amphitheater and adjoining peace walk will be built on the banks of Belmont Bay. The theater will host cultural ceremonies, performances and informal gatherings.
- **Fellow Housing.** Group-living accommodations will be provided for six doctoral students. Two apartment-style units will be built at the wood's edge.
- **Lynch House.** As the physical and emotional center of Point of View, the Lynch home will be modified to host small groups with meetings rooms for up to 16, several break-out spaces, faculty offices, administrative office and catering kitchen.



Rendering by Bushman Dreyfus Architects PLC

▲ Open, glassed enclosed lecture hall and welcome building.

Cost: \$6.1 million

Completed: Spring 2010



PHASE II: ANCHORING DIALOGUE

OVERNIGHT RETREAT COMPLEX

The complex will provide a comfortable, modern overnight space for open dialogue and active learning. It will accommodate up to fifteen guests for multiple-day events and be open to ICAR, George Mason University and ICAR partners, as well as educational, government, corporate and nonprofit institutions.

Towering trees that have long graced the peninsula will surround the complex, allowing the beauty of nature to contribute toward peace building.

The Retreat Complex will include:

- **Lynch House.** With extensive renovation and expansion, the Lynch home will be able to host large meeting groups of up to thirty. It will offer relaxing lounges, a kitchen and faculty offices.
- **Guest Rooms.** Fifteen guest rooms will be designed for quiet seclusion and offer serene views of the adjacent marsh.
- **Dining and Recreational Building.** To accommodate

overnight guests and larger meeting groups, the new dining area will be open and bright. Overnight guests will enjoy indoor recreational facilities.

Cost: \$9.1 million

Completed: Spring 2012

▲ Private student housing.



Photo by Amanda Martin

PHASE III: DISCOVERY AND CELEBRATION:

INTERNATIONAL SCHOLARLY HUB

The third phase will focus on academic research and bringing the international community to Point of View. Faculty experts from all over the world will convene to advance research on topics related to conflict studies, including coexistence, conflict prevention and reconciliation. They will be able to study in the library, explore the archive and meditate at the reflective pool.

During the final phase, Point of View will expand its overnight and research capacity by adding:

- **Conflict Resolution Ceremonial and Performance Hall.** This new facility will be built at the center of the Point of View campus for engagement, entertainment and meditation. It will feature superb acoustics, a ground-level terrace overlooking the Bay and an underground reflective pool.
- **Library and Research Center.** A first-class library will support the research and scholarly work at Point of View with research stations, study carrels and fellows offices.
- **Archive.** Point of View will become a major repository for the papers and artifacts of the field of conflict resolution. It will be a resource for students, faculty and practitioners from around the world.
- **Guest Rooms.** Twenty guest rooms will be added for overnight accommodations. The new rooms will be built adjacent to the existing guest rooms with the same privacy and seclusion.



Rendering by Bushman Dreyfus Architects PLC

▲ Outdoor woodland amphitheater built on natural land form.

Cost: \$8.7 million

Completed: Spring 2014

“Through a blend of private and public funds, I believe we can materialize the dream of Ed and Helen Lynch and advance the field of conflict resolution.”

—GENE SMITH, CHAIR, POINT OF VIEW CAMPAIGN





POINT
of VIEW

POINT *of* VIEW

Institute for Conflict Analysis and Resolution

George Mason University
3401 N. Fairfax Drive
MSN 4D3
Arlington, VA 22201

Tel.: 703-993-1300
Fax: 703-993-1302
Website: icar.gmu.edu/pov

